

RG11-S60-CCS
coax cable



Standard construction

- 14 gauge (1,63 mm) copper covered steel center conductor
- Foamed PE, bounded foil, 60% braid, PVC jacket
- Gas expanded polyethylene dielectric
- Aluminium-polypropylene-aluminium laminated tape inner shield with overlap bounded to dielectric
- 34 AWG bare aluminium braid wire outer shield
- Black polyvinylchloride jacket

Electrical characteristics

Nominal impedance	75 Ω
Nominal velocity of propagation	85 %
Shielding effectiveness	> 100 dB

Physical Dimensions

component	Ø (mm)
Nominal center conductor diameter	1,63
Nominal diameter over dielectric	7,11
Nominal diameter over first shield (tape)	7,29
Nominal diameter over jacket	10,03
Nominal jacket wall thickness	1,07

Attenuation (@ 20°C)

frequency (MHz)	max. loss (dB/100m)
5	1,25
55	3,15
83	3,87
187	5,74
211	6,23
250	6,72
300	7,38
350	7,94
400	8,53
450	9,02
500	9,51
550	9,97
600	10,43
750	11,97
865	13,05
1000	14,27

Reel parameters

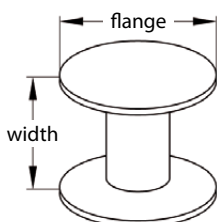

width: 360 mm
 flange: 395 mm
 weight: 24 kg
 cable length: 305 m

RG11-S60-M
coax cable



Standard, messengered construction

- 14 gauge (1,63 mm) copper center conductor
- Foamed PE, bounded foil, 60% braid, PVC jacket, steel messenger
- Gas expanded polyethylene dielectric
- Aluminium-polypropylene-aluminium laminated tape inner shield with overlap bounded to dielectric
- 34 AWG bare aluminium braid wire outer shield
- Black polyvinylchloride jacket
- Minimum breaking strength of messenger 166 kg, @1,83 mm

Electrical characteristics

Nominal impedance	75 Ω
Nominal velocity of propagation	85 %
Shielding effectiveness	> 100 dB

Physical Dimensions

component	∅ (mm)
Nominal center conductor diameter	1,63
Nominal diameter over dielectric	7,11
Nominal diameter over first shield (tape)	7,29
Nominal diameter over jacket	10,03
Nominal jacket wall thickness	1,07
Nominal diameter of steel messenger	1,83

Attenuation (@ 20°C)

frequency (MHz)	max. loss (dB/100m)
5	1,25
55	3,15
83	3,87
187	5,74
211	6,23
250	6,72
300	7,38
350	7,94
400	8,53
450	9,02
500	9,51
550	9,97
600	10,43
750	11,97
865	13,05
1000	14,27

Reel parameters

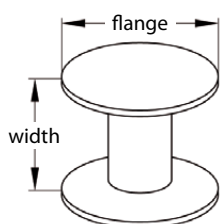

width: 350 mm
 flange: 440 mm
 weight: 38 kg
 cable length: 305 m

RG11-T60-HCU
coax cable



Tri-shield construction

- 14 gauge (1,63 mm) copper center conductor
- Foamed PE, bounded foil, 60% braid, non-bounded tape, PVC jacket
- Gas expanded polyethylene dielectric
- Aluminium-polypropylene-aluminium laminated tape inner shield with overlap bounded to dielectric
- 34 AWG bare aluminium braid wire outer shield
- White polyvinylchloride jacket

Electrical characteristics

Nominal impedance	75 Ω
Nominal velocity of propagation	85 %
Shielding effectiveness	> 100 dB

Physical Dimensions

component	Ø (mm)
Nominal center conductor diameter	1,63
Nominal diameter over dielectric	7,11
Nominal diameter over first shield (tape)	7,29
Nominal diameter over jacket	10,03
Nominal jacket wall thickness	0,99

Attenuation (@ 20°C)

frequency (MHz)	max. loss (dB/100m)
5	1,25
55	3,15
83	3,87
187	5,74
211	6,23
250	6,72
300	7,38
350	7,94
400	8,53
450	9,02
500	9,51
550	9,97
600	10,43
750	11,97
865	13,05
1000	14,27

Reel parameters

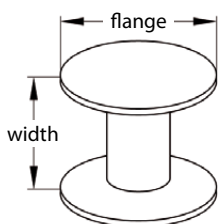

width: 360 mm
 flange: 400 mm
 weight: 35 kg
 cable length: 305 m

RG11-T60-CCS
coax cable



Tri-shield construction

- 14 gauge (1,63 mm) copper covered steel center conductor
- Foamed PE, bounded foil, 60% braid, non-bounded tape, PVC jacket
- Gas expanded polyethylene dielectric
- Aluminium-polypropylene-aluminium laminated tape inner shield with overlap bounded to dielectric
- 34 AWG bare aluminium braid wire outer shield
- Black polyvinylchloride jacket

Electrical characteristics

Nominal impedance	75 Ω
Nominal velocity of propagation	85 %
Shielding effectiveness	> 100 dB

Physical Dimensions

component	∅ (mm)
Nominal center conductor diameter	1,63
Nominal diameter over dielectric	7,11
Nominal diameter over first shield (tape)	7,29
Nominal diameter over jacket	10,03
Nominal jacket wall thickness	0,99

Attenuation (@ 20°C)

frequency (MHz)	max. loss (dB/100m)
5	1,25
55	3,15
83	3,87
187	5,74
211	6,23
250	6,72
300	7,38
350	7,94
400	8,53
450	9,02
500	9,51
550	9,97
600	10,43
750	11,97
865	13,05
1000	14,27

Reel parameters

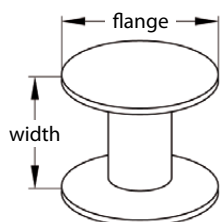

width: 365 mm
 flange: 370 mm
 weight: 35 kg
 cable length: 305 m

RG11-T60-F-CCS
coax cable



Tri-shield, flooded construction

- 14 gauge (1,63 mm) copper covered steel center conductor
- Foamed PE, bounded foil, 60% braid, non-bounded tape, flooded for underground, PE jacket
- Gas expanded polyethylene dielectric
- Aluminium-polypropylene-aluminium laminated tape inner shield with overlap bounded to dielectric
- 34 AWG bare aluminium braid wire outer shield
- Black polyethylene jacket

Electrical characteristics

Nominal impedance	75 Ω
Nominal velocity of propagation	85 %
Shielding effectiveness	> 100 dB

Physical Dimensions

component	∅ (mm)
Nominal center conductor diameter	1,63
Nominal diameter over dielectric	7,11
Nominal diameter over first shield (tape)	7,29
Nominal diameter over jacket	10,03
Nominal jacket wall thickness	0,99

Attenuation (@ 20°C)

frequency (MHz)	max. loss (dB/100m)
5	1,25
55	3,15
83	3,87
187	5,74
211	6,23
250	6,72
300	7,38
350	7,94
400	8,53
450	9,02
500	9,51
550	9,97
600	10,43
750	11,97
865	13,05
1000	14,27

Reel parameters

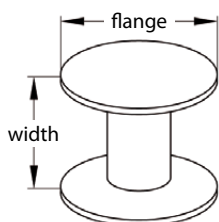

width: 355 mm
 flange: 440 mm
 weight: 25 kg
 cable length: 305 m

RG11-T60-M
coax cable



Tri-shield, messengered construction

- 14 gauge (1,63 mm) copper center conductor
- Foamed PE, bounded foil, 60% braid, non-bounded tape, PVC jacket, steel messenger
- Gas expanded polyethylene dielectric
- Aluminium-polypropylene-aluminium laminated tape inner shield with overlap bounded to dielectric
- 34 AWG bare aluminium braid wire outer shield
- Black polyvinylchloride jacket
- Minimum breaking strength of messenger 166 kg, @1,83 mm

Electrical characteristics

Nominal impedance	75 Ω
Nominal velocity of propagation	85 %
Shielding effectiveness	> 100 dB

Physical Dimensions

component	∅ (mm)
Nominal center conductor diameter	1,63
Nominal diameter over dielectric	7,11
Nominal diameter over first shield (tape)	7,29
Nominal diameter over jacket	10,03
Nominal jacket wall thickness	0,99
Nominal diameter of steel messenger	1,83

Attenuation (@ 20°C)

frequency (MHz)	max. loss (dB/100m)
5	1,25
55	3,15
83	3,87
187	5,74
211	6,23
250	6,72
300	7,38
350	7,94
400	8,53
450	9,02
500	9,51
550	9,97
600	10,43
750	11,97
865	13,05
1000	14,27

Reel parameters

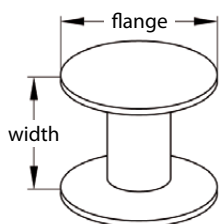

width: 350 mm
 flange: 440 mm
 weight: 40 kg
 cable length: 305 m

RG11-T60-M-CCS
coax cable



Tri-shield, messengered construction

- 14 gauge (1,63 mm) copper covered steel center conductor
- Foamed PE, bounded foil, 60% braid, non-bounded tape, PVC jacket, steel messenger
- Gas expanded polyethylene dielectric
- Aluminium-polypropylene-aluminium laminated tape inner shield with overlap bounded to dielectric
- 34 AWG bare aluminium braid wire outer shield
- Black polyvinylchloride jacket
- Minimum breaking strength of messenger 166 kg_f @1,83 mm

Electrical characteristics

Nominal impedance	75 Ω
Nominal velocity of propagation	85 %
Shielding effectiveness	> 100 dB

Physical Dimensions

component	∅ (mm)
Nominal center conductor diameter	1,63
Nominal diameter over dielectric	7,11
Nominal diameter over first shield (tape)	7,29
Nominal diameter over jacket	10,03
Nominal jacket wall thickness	0,99
Nominal diameter of steel messenger	1,83

Attenuation (@ 20°C)

frequency (MHz)	max. loss (dB/100m)
5	1,25
55	3,15
83	3,87
187	5,74
211	6,23
250	6,72
300	7,38
350	7,94
400	8,53
450	9,02
500	9,51
550	9,97
600	10,43
750	11,97
865	13,05
1000	14,27

Reel parameters

	width: 360 mm
	flange: 440 mm
	weight: 41 kg
	cable length: 305 m